

Line of ultra-thin linear lamps with uniform light emission, designed to obtain an extremely clean result.



Example of FLUSH with magnets and FLUSH upright laying on existing

## Technical Specs

INPUT VOLTAGE	24V DC
DRIVER	AC DC 24V DC OUTPUT (class 2 Power Unit)
DIMMABILITY	YES by all existing systems (0-10V, Dali, DMX, ELV/MLV, Lutron Ecosystem, ... )
POWER CONSUMPTION	Standard bright 4.5 W per linear ft (14 W per linear meter) High bright 9 W per linear ft (28 W per linear meter)
LUMEN DELIVERED	Standard bright 290 lm per linear ft (890 lm per linear meter) High bright 580 lm per linear ft (1780 lm per linear meter)
IP GRADE	IP 40 - suitable for Dry Location (IP 54 - Damp Location under request)
CRI	> 95
WEIGHT	5.7 lbs/sq. ft (25 Kg/sq. mt)
LIFE TIME	70.000 hrs
WARRANTY	3 Years (36 months)
CERTIFICATIONS	 <ul style="list-style-type: none"> <li>• Ceiling surface Mounted</li> <li>• Ceiling recessed Type IC Inherently protected</li> <li>• Wall surface Mounted</li> <li>• Storage Area of a Clothes Closet</li> </ul>

## Size

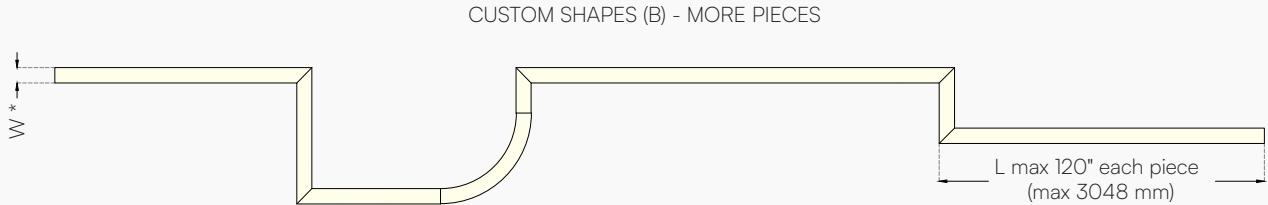
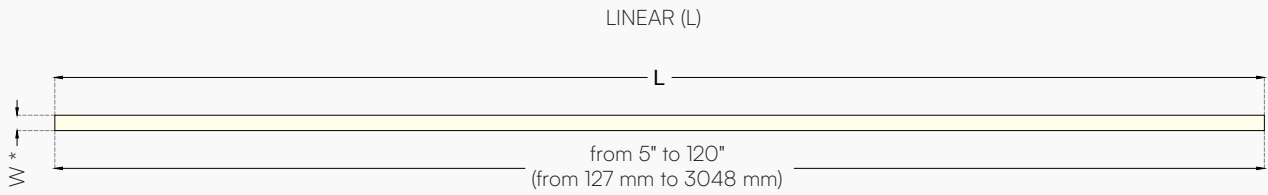

\* Standard Width 0.6" - 1" - 1.2" - 1.4" - 1.6" - 2" - 3" - 4" - 6" - 8"

\* Standard Width 15.24 - 25.4 - 30.48 - 35.56 - 40.64 - 50.8 - 76.2 - 101.6 - 152.4 - 203.2 mm

\* Custom Width from 0.6" to 8"

\* Custom Width from 15.24 mm to 203.2 mm

### SECTION OF FLUSH (no mounting system)

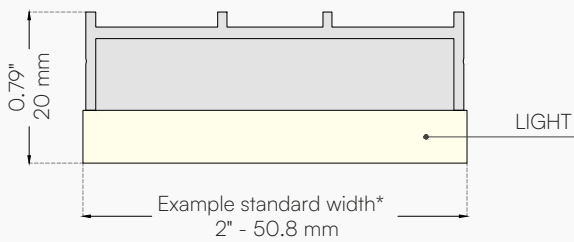

### TYPE OF MITERED CORNES:

Mitered corner 2D

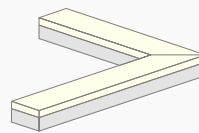

Mitered corners 3D

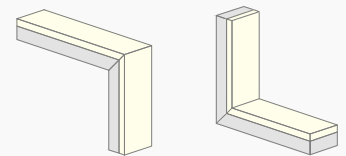

Name	Use *	Size *	Kelvin **	Brightness	Dimming	Mounting system *
FLUSH	Ceiling Wall Floor Cabinet Mirror	L - linear (Width x Length)  B - bespoke (Need CAD drawing)	<ul style="list-style-type: none"> <li><span style="color: orange;">●</span> 2000 K</li> <li><span style="color: orange;">●</span> 2700 K</li> <li><span style="color: yellow;">●</span> 3000 K</li> <li><span style="color: lightgrey;">●</span> 3500 K</li> <li><span style="color: lightblue;">●</span> 4100 K</li> <li><span style="color: lightblue;">●</span> 5000 K</li> <li><span style="color: orange;">●</span> Dim to Warm **</li> <li><span style="color: orange;">●</span> Tun W (18K-32K / 3 wires)</li> <li><span style="color: orange;">●</span> Tun W (24K-41K / 3 wires)</li> <li><span style="color: red;">●</span> <span style="color: green;">●</span> <span style="color: blue;">●</span> RGB</li> </ul>	Standard bright (4.5 W/ft - 14 W/mt)  High bright (9 W/ft - 28 W/mt)	No dimming 0-10V Dali DMX ELV/MLV Lutron Ecosystem	No mounting system Magnetic Steel Cords (Shy suspended) Uplight (Laying on existing)

\* Backlight reserves the right to modify and advise in case the dimension of the panel doesn't allow to use the system selected.

\*\* Other Kelvin, Dim to Warm (19K-30K / 2 wires), RGBW and RGBTW under request.

### Cable options

A - end feed    B - backfeed    C - side feed

BKL < 42W    1 cable  
BKL > 42W    2 cables

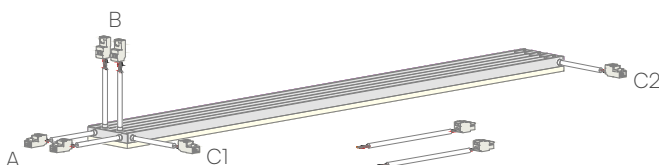

Cables from BKL ~ 20" (500 mm) + Extension cables ~ 40" (1000 mm)  
Custom length of cables under request. BKL \_\_\_\_\_ + Exten \_\_\_\_\_

### Other options

IP: IP40 (Dry location) or IP54 (Damp location)

FINISH: Standard RAL 9003  
(Custom RAL \_\_\_\_\_ under request)

PRINTING: Printing on Backlight surface using a new UV technology  
(High Resolution file needed)

FACE WORKING: Lowering of the surface for your framing accomodation

NOTE: \_\_\_\_\_  
\_\_\_\_\_  
\_\_\_\_\_

### Mounting system

MAGNETIC SURFACE

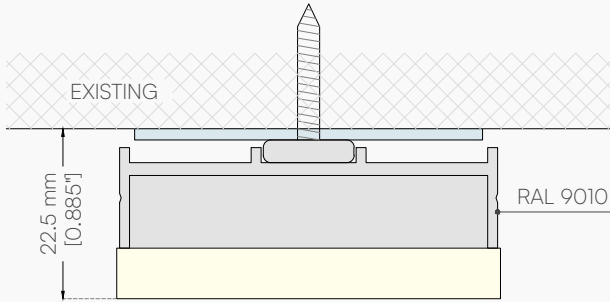

MAGNETIC RECESSED

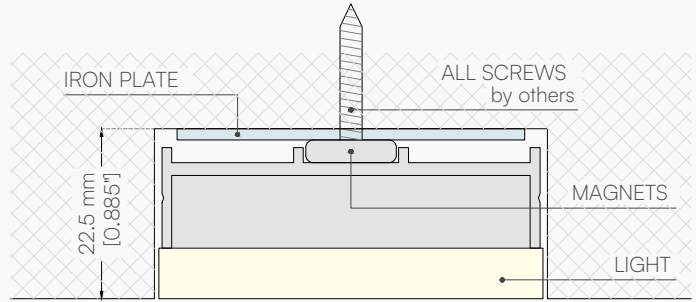

STEEL CORDS (Shy suspended)

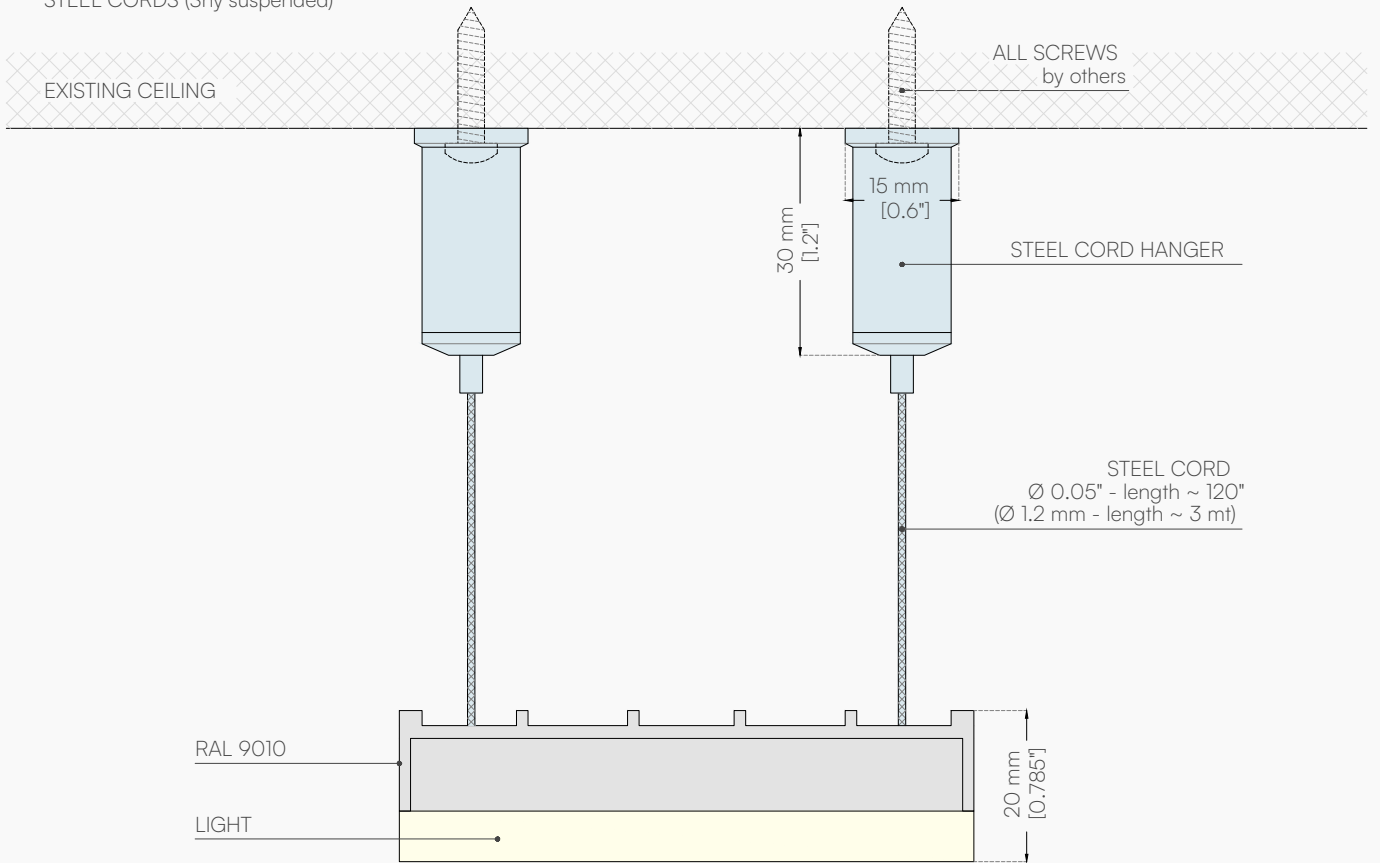

UPLIGHT (Laying on existing - no mounting system)

